

Nr. Pct.	Coordonate pct. de contur		Lungimi latari (LxJ+1)
	X [m]	Y [m]	
1	561645.059	412230.560	1.398
2	561644.713	412231.915	2.960
3	561644.514	412234.888	2.912
4	561644.721	412231.773	4.559
5	561646.209	412242.082	2.906
6	561647.818	412244.502	5.520
7	561651.713	412245.414	3.857
8	561655.216	412250.027	2.032
9	561657.197	412250.479	113.821
10	561767.731	412273.536	4.774
11	561772.145	412275.291	4.270
12	561775.884	412281.353	3.039
13	561778.364	412283.110	3.672
14	561781.033	412283.630	3.904
15	561783.438	412288.707	2.649
16	561784.743	412291.012	4.869
17	561786.522	412295.504	4.328
18	561787.608	412299.718	4.522
19	561787.851	412304.233	2.744
20	561787.852	412306.970	2.704
21	561787.213	412309.638	23.883
22	561781.563	412332.843	143.734
23	561747.561	412472.497	2.097
24	561747.096	412474.542	3.158
25	561747.005	412477.699	3.389
26	561747.643	412481.027	4.034
27	561749.165	412484.763	3.122
28	561750.993	412487.294	4.178
29	561754.107	412490.079	3.985
30	561757.521	412491.369	2.120
31	561759.691	412492.418	161.658
32	561916.759	412530.667	177.283
33	562089.008	412572.812	92.368
34	562178.713	412594.466	10.502
35	562188.939	412597.021	17.375
36	562205.711	412601.560	7.790
37	562213.196	412603.720	20.085
38	562232.388	412608.644	11.116
39	562242.965	412613.064	18.797
40	562260.922	412616.621	15.614
41	562275.941	412622.891	14.165
42	562289.641	412626.491	1.771
43	562289.245	412626.217	8.322
44	562289.022	412625.860	1.149
45	562273.307	412632.538	15.817
46	562258.093	412626.212	19.057
47	562229.888	412622.579	11.115
48	562229.312	412619.159	19.915
49	562210.287	412613.271	7.592
50	562202.868	412611.182	27.507
51	562176.387	412604.182	269.651
52	561914.395	412540.372	468.488
53	561459.206	412429.539	2.307
54	561460.455	412427.390	7.722
55	561461.523	412419.811	78.440
56	561637.736	412438.370	102.999
57	561637.811	412432.739	82.444
58	561717.914	412482.245	1.927
59	561719.789	412482.691	3.537
60	561723.322	412482.869	5.633
61	561728.773	412481.449	5.197
62	561733.072	412478.528	4.150
63	561735.707	412475.322	2.977
64	561737.054	412472.667	2.015
65	561737.683	412470.753	0.630
66	561737.828	412470.140	40.027
67	561747.498	412431.252	40.000
68	561756.772	412392.388	40.001
69	561766.236	412353.523	47.601
70	561777.498	412307.273	1.450
71	561777.823	412305.860	2.348
72	561778.051	412303.523	3.515
73	561777.811	412300.016	3.584
74	561776.719	412295.602	3.686
75	561774.768	412293.472	3.439
76	561772.483	412290.902	3.304
77	561769.789	412288.369	2.110
78	561767.860	412288.134	1.387
79	561766.564	412287.639	1.231
80	561765.367	412287.352	113.829
81	561654.825	412260.194	4.800
82	561650.354	412258.447	8.057
83	561643.538	412254.150	7.791
84	561638.817	412248.110	6.823
85	561635.808	412241.892	6.953
86	561634.674	412236.032	6.894
87	561635.348	412232.171	109.132
88	561661.419	412122.199	80.043
89	561680.541	412044.474	58.320
90	561694.473	411987.843	21.717
91	561699.585	411966.736	80.010
92	561718.419	411888.974	33.671
93	561726.326	411866.245	31.629
94	561714.519	411826.697	20.356
95	561719.341	411806.908	24.694
96	561695.348	411801.065	159.881
97	561640.006	411763.238	8.512
98	561536.253	411755.598	294.998
99	561282.906	411644.669	237.249
100	561278.460	411607.930	4.402
101	561278.569	411603.529	21.625
102	561260.065	411393.130	3.584
103	561257.625	411390.505	19.551
104	561275.860	411383.454	35.386
105	561308.866	411370.691	44.041
106	561349.872	411354.626	35.615
107	561383.069	411341.727	65.424
108	561443.880	411317.595	24.963
109	561467.051	411308.308	199.113
110	561501.551	411294.409	15.628
111	561504.294	411519.998	6.118
112	561504.834	411523.069	37.891
113	561536.188	411544.374	15.376
114	561548.072	411553.857	3.336
115	561548.058	411557.186	22.450
116	561670.497	411556.482	36.380
117	561599.480	411576.470	50.495
118	561634.550	411614.800	17.307
119	561645.720	411628.020	41.421
120	561671.500	411660.440	28.077
121	561689.510	411681.980	25.802
122	561704.460	411703.010	36.543
123	561728.393	411730.625	19.127
124	561739.300	411746.337	39.564
125	561756.227	411771.786	42.858
126	561746.814	411813.598	8.938
127	561744.851	411822.318	172.750
128	561704.188	411990.214	247.513

S(1)=135914.36mp P=4902.526m

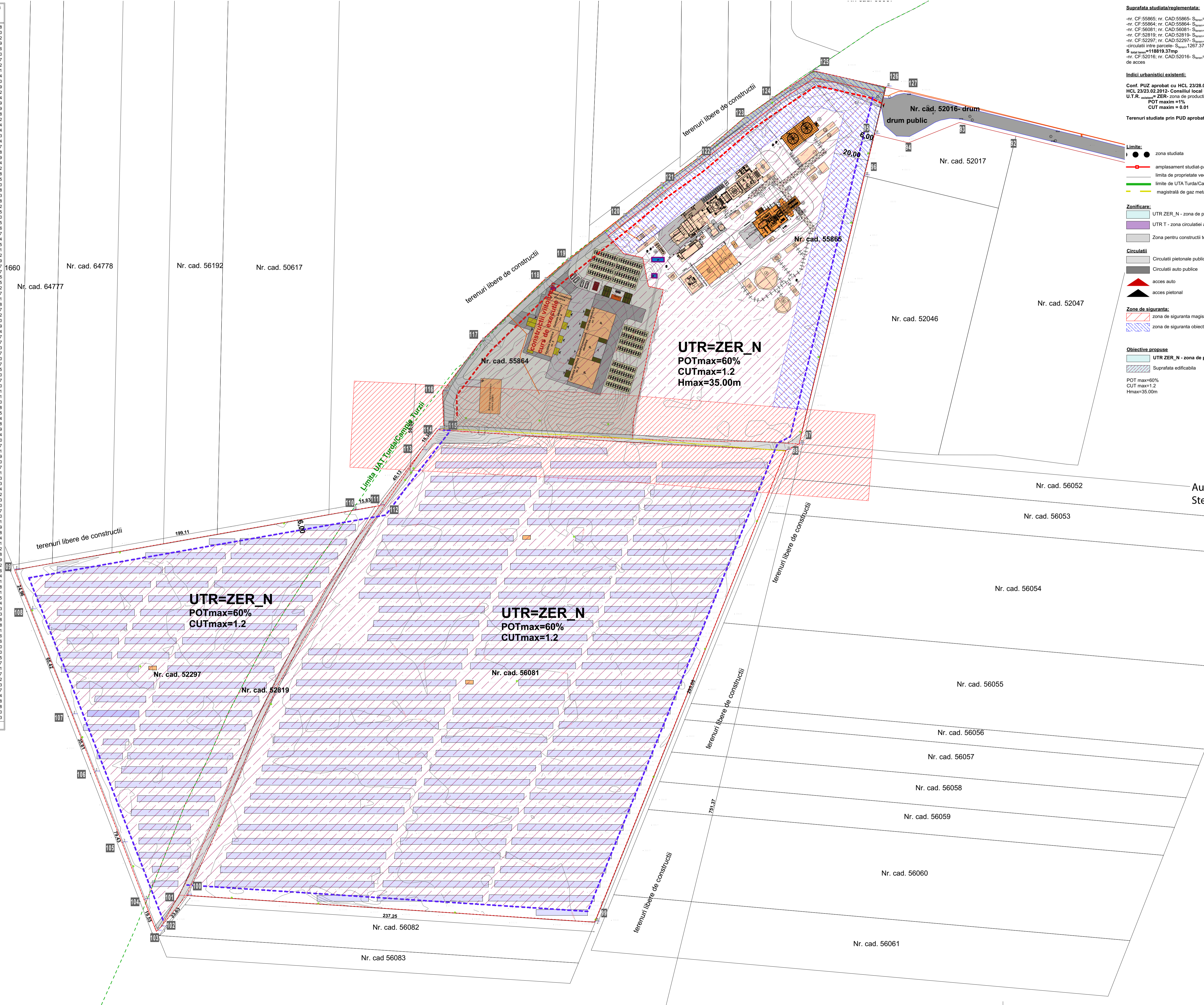

**Suprafata studiata/reglementata:**  
 -nr. CF:55865; nr. CAD:55865- S<sub>max</sub>=20851.00mp (UAT-Campia Turzii)  
 -nr. CF:55864; nr. CAD:55864- S<sub>max</sub>=10541.00mp (UAT-Campia Turzii)  
 -nr. CF:56081; nr. CAD:56081- S<sub>max</sub>=63300.00mp (UAT-Campia Turzii)  
 -nr. CF:52819; nr. CAD:52819- S<sub>max</sub>=4165.00mp (UAT-Campia Turzii)  
 -nr. CF:52297; nr. CAD:52297- S<sub>max</sub>=18695.00mp (UAT-Turda)  
 -circulatii intre parcele: S<sub>max</sub>=1267.37mp  
 S<sub>max</sub> total=118819.37mp  
 -nr. CF:52016; nr. CAD:52016- S<sub>max</sub>=17205.00mp (UAT-Campia Turzii)- drum de acces

**Indici urbanistici existenti:**  
 Conf. PUZ aprobat cu HCL 23/28.02.2012-Consiliul local Municipiul Turda/  
 HCL 23/23.02.2012-Consiliul local Campia Turzii:  
 U.T.R. zona=ZER- zona de productie energie regenerabila  
 POT maxim =1%  
 CUT maxim = 0.01

**Terenuri studiate prin PUD aprobat cu HCL nr. 17/24.09.2020**

**Limite:**  
 ● zona studiata  
 ● limita de proprietate vecinatai  
 ● limita de UTA Turda/Campia Turzii  
 ● magistrala de gaz metan

**Zonificare:**  
 UTR ZER\_N - zona de productie energie  
 UTR T - zona circulatiei auto si pietonale  
 Zona pentru constructii tehnico-edilitare

**Circulatii:**  
 Circulatii pietonale publice  
 Circulatii auto publice  
 acces auto  
 acces pietonal

**Zone de siguranta:**  
 zona de siguranta magistrala de gaz-50m  
 zona de siguranta obiective energetice MT si IT (statie)-20m

**Obiective propuse**  
 UTR ZER\_N - zona de productie energie  
 Suprafata edificabila  
 POT max=60%  
 CUT max=1.2  
 Hmax=35.00m

Aura Stefanache  
 Digitally signed by Aura Stefanache  
 Date: 2021.10.12 12:56:01 +03'00'

Orientare

**LINE PUNCT**  
 PROIECTANT DE SPECIALITATE URBANISM  
 S.C. LINE PUNCT S.R.L.  
 str. Alexandru Vlahuta, Iama B, Cluj-Napoca,  
 email: arh.corina.moldovan@gmail.ro  
 tel: 0757.706.706

PROIECTANT GENERAL  
**sc bogart construct srl**  
 Cluj-Napoca Romania  
 Romania 1 Decembrie 1918, nr. 38, etaj 9, Cluj-Napoca  
 Tel: 0769.448282 / 0769.448283 / 0769.448284  
 www.bogartconstruct.ro / email: office@bogartconstruct.ro / office@bogartconstruct.ro

Coordonator arh. urb. Corina MOLDOVAN  
 urbanism: arh. Mirela PETRINA  
 proiectare: arh. Iulia GHIBU  
 arh. Dan Ovidiu POP

Obiectivul:  
 PUZ de actualizare Plan urbanistic zonal-Centrala Fotovoltaica-2012 in vederea realizarii Ansamblului Energetic Nova Power&Gas Campia Turzii, pentru producerea energiei electrice si termice in ciclu combinat, inclusiv cogenerare

Adresa:  
 CF nr. 55865; 56081; 55864; 52819; 52016-Campia Turzii, CF nr. 52297-Turda, jud. Cluj

Beneficiar/a/i:  
 SC NOVA POWER & GAS SRL  
 Cluj Napoca, str. Calea Turzii nr. 217, jud. Cluj

Nr. proiect	Faza:
10.2021	P.U.Z.

Denumire plansa:  
 Plan posibilitate de mobilare

Data	Scara	Plansa nr.
12.2021	1:1000	U./P.U.Z./04